

## Gaskets

### **PG Gasket - for BSP/ISO parallel threads (PG)**

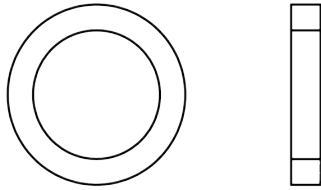

Provides a pressure seal with RELYLOK PG designated BSP/ISO parallel threads. Standard material is Copper.

Male BSP/ISOP in.	RELYLOK Part No.
1/4	CU-4-PG
3/8	CU-6-PG
1/2	CU-8-PG

### **PP Gasket - for BSP/ISO parallel threads (PP)**

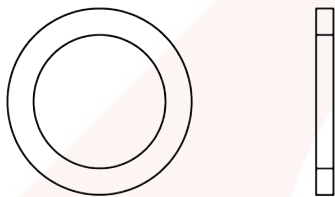

Provides a pressure seal with RELYLOK PP designated BSP/ISO parallel threads. Standard material is Copper.

Male BSP/ISOP in.	RELYLOK Part No.
1/8	CU-2-PP
1/4	CU-4-PP
3/8	CU-6-PP
1/2	CU-8-PP
3/4	CU-12-PP
1	CU-16-PP
1 1/4	CU-20-PP
1 1/2	CU-24-PP

### **PS Gasket - for BSP/ISO parallel threads (PS)**

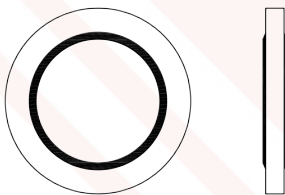

Provides a high pressure seal with RELYLOK PS designated BSP/ISO parallel threads, with an inner ring of FKM (Viton) bonded with 316 stainless steel. To order with Buna-N inner ring, replace -VI in the part number with -BN. Example: SS-4-PS-**BN**.

Male BSP/ISOP in.	RELYLOK Part No.
1/16	SS-1-PS-VI
1/8	SS-2-PS-VI
1/4	SS-4-PS-VI
3/8	SS-6-PS-VI
1/2	SS-8-PS-VI
3/4	SS-12-PS-VI
1	SS-16-PS-VI
1 1/4	SS-20-PS-VI
1 1/2	SS-24-PS-VI
2	SS-32-PS-VI