

PS Gasket

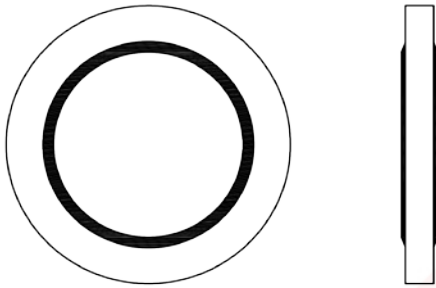

For BSP/ISO parallel (PS) thread

Provides a high pressure seal with RELYLOK PS designated BSP/ISO parallel threads, with an inner ring of FKM (Viton) bonded with 316 stainless steel. To order with Buna-N inner ring, replace -VI in the part number with -BN. Example: SS-4-PS-**BN**.

P - Male BSPP/ISOP in.	RELYLOK Part No.
1/16	SS-1-PS-VI
1/8	SS-2-PS-VI
1/4	SS-4-PS-VI
3/8	SS-6-PS-VI
1/2	SS-8-PS-VI
3/4	SS-12-PS-VI
1	SS-16-PS-VI
1-1/4	SS-20-PS-VI
1-1/2	SS-24-PS-VI
2	SS-32-PS-VI

PG Gasket

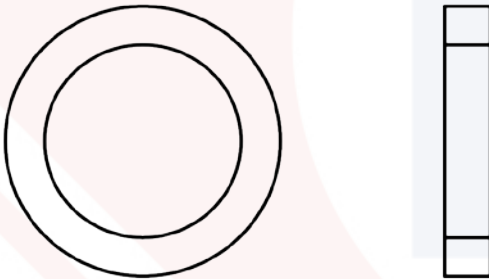

For BSP/ISO parallel (PG) thread

Provides a pressure seal with RELYLOK PG designated BSP/ISO parallel thread in Gauge Adapters. Standard material is Copper. Nickel is available on request. To order in nickel, replace CU in the part number with NI. Example: **NI**-4-PG.

P - Male BSPP/ISOP in.	RELYLOK Part No.
1/4	CU-4-PG
3/8	CU-6-PG
1/2	CU-8-PG