

## Bulkhead Reducing Unions

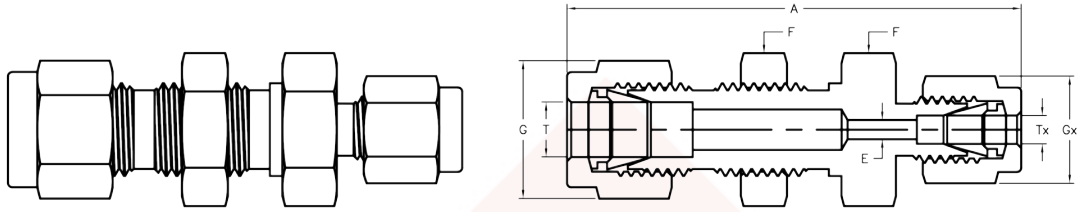

### Fractional tube

RELYLOK Basic Part No.	T Tube O.D.	Tx Tube O.D.	A in. [mm]	E in. [mm]	F Hex	G Hex	Gx Hex	Panel Hole Size	Max. Panel Thickness in. [mm]
-2-101-1	1/8	1/16	1.85 [47]	0.05 [1.3]	1/2	7/16	5/16	21/64	0.50 [12.7]
-4-101-2	1/4	1/8	2.17 [55.1]	0.09 [2.3]	5/8	9/16	7/16	29/64	0.40 [10.2]
-6-101-4	3/8	1/4	2.39 [60.7]	0.19 [4.8]	3/4	11/16	9/16	37/64	0.44 [11.2]
-8-101-4	1/2	1/4	2.63 [66.8]	0.19 [4.8]	15/16	7/8	9/16	49/64	0.50 [12.7]

### Metric tube to Fractional tube

RELYLOK Basic Part No.	T Tube O.D.	Tx Tube O.D.	A mm.	E mm.	F Hex	G Hex	Gx Hex	Panel Hole Size	Max. Panel Thickness mm.
-M6-101-2	6	1/8	55.1	2.4	16	14	11	11.5	10.2

See Ordering Information and Technical Specifications on page 4.